



REPORT

SUBJECT: PROPOSED 30MPH SPEED LIMIT, R122 (CRICK TO SHIRENEWTON), CRICK.
MEETING: Individual Cabinet Member
DATE: 13th July 2016
DIVISION/WARDS AFFECTED: CAERWENT/SHIRENEWTON

1. PURPOSE:

To consider the proposed order subsequent to representations received following advertisement in accordance with the Local Authorities Traffic Orders (Procedure) (England and Wales) Regulations 1994.

2. RECOMMENDATIONS:

Not to hold a public inquiry and to proceed to approve and implement the proposed order. Those persons that have forwarded objections are informed of the Councils decision.

3. KEY ISSUES:

Monmouthshire County Council proposes to introduce a 30mph speed limit on a section of the R112 from its junction with the A48 for a distance of 294 metres. This restriction is proposed in order to reduce travelling speeds through a residential area where increased pedestrian movements occur. A number of junctions will also be covered by the proposals including an access

road to a County Council Highways Depot. These proposals will contribute to creating a safer highway environment for all road users.

4. REASONS:

The proposed order is considered to be required in the interests of road safety and to promote lower vehicular speeds.

Regulation 9 of the Local Authorities' Traffic Orders (Procedure) (England and Wales) Regulations 1996 enables the Council to hold a public inquiry into the proposal if there are unresolved objections. In this instance there has been no objections received

5. RESOURCE IMPLICATIONS:

The cost of making the Traffic Regulation Order will be funded from the Council's Road Safety and Traffic Management budget.

6. SUSTAINABLE DEVELOPMENT IMPLICATIONS:

There are no sustainability issues regarding the introduction of a 30mph speed limit along this route.

7. CONSULTEES:

Corporate Management Team
County Councillor S. B. Jones, Cabinet Member for County Operations
County Councillor G Down, Local Member for Shirenewton Ward
County Councillor P Murphy, Local Member for Caerwent Ward

8. RESULTS OF CONSULTATION

No objections were received

9. BACKGROUND PAPERS:

Schedule of Measurements, Statement of Reasons, Drawing No.1679

10. AUTHOR: Paul Keeble – Traffic & Network Manager

11. CONTACT DETAILS:

Tel: 01633 644733

Email: paulkeeble@monmouthshire.gov.uk

R122 (CRICK TO SHIRENEWTON), CRICK

30MPH SPEED LIMIT ORDER 2016

Schedule of Measurements

30mph Speed Limit

1. R122

- (i) From its junction with the A48 for a distance of 294 metres in a north easterly direction.**

Statement of Reasons

Following representations received from the local community and Local Elected Member, Monmouthshire County Council proposes to introduce a 30mph speed limit on the R122. This measure is required to reduce travelling speeds through a residential area where increased pedestrian movements occur. A number of junctions will also be covered by the proposals including an access road to a County Council Highways Depot. These proposals will contribute to creating a safer highway environment for all road users.

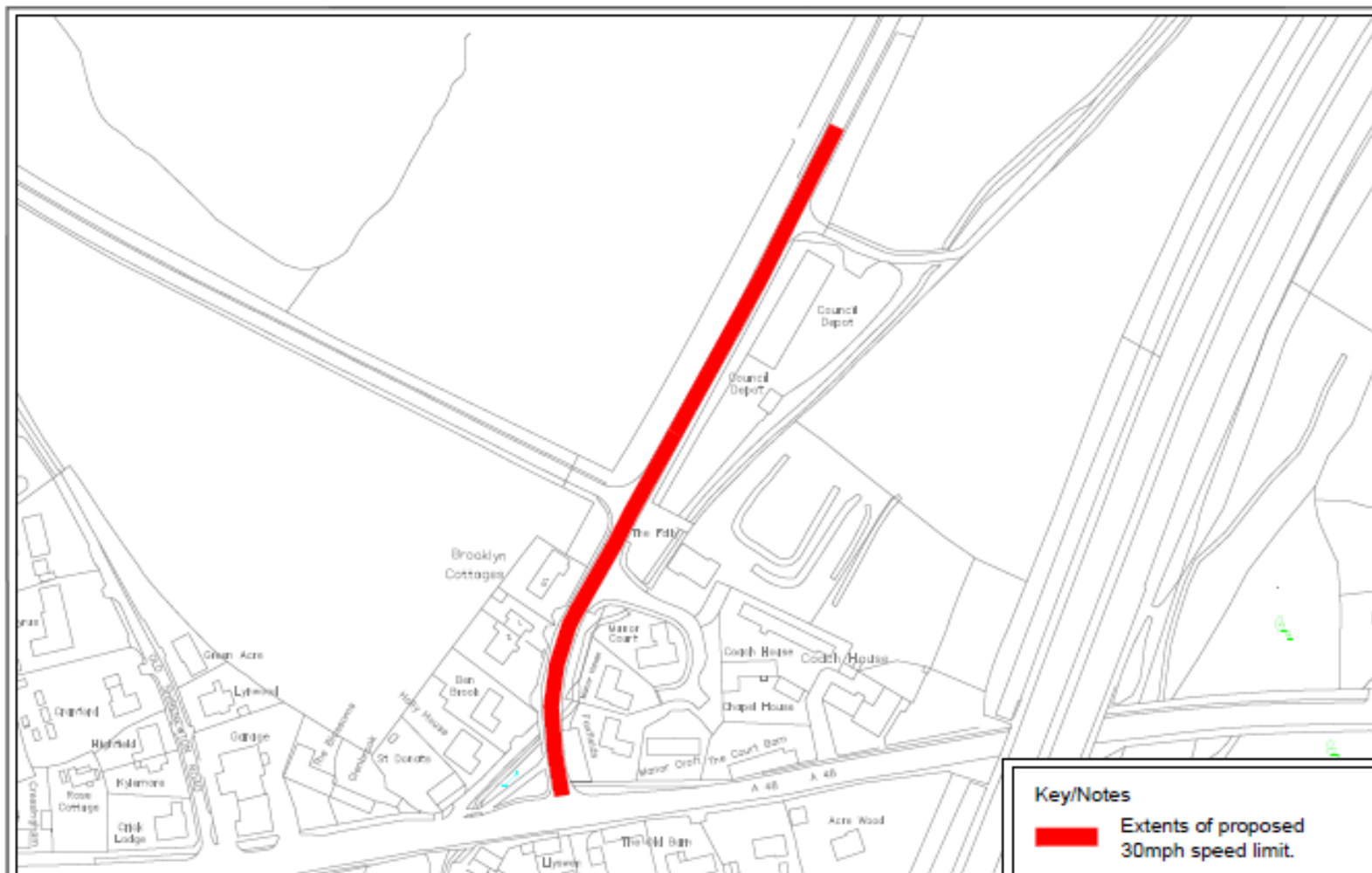

Key/Notes

 Extents of proposed 30mph speed limit.



nonmouthshire
COUNTY COUNCIL
at Jersey

ROGER HOGGINS
HEAD OF INFRASTRUCTURE, NETWORKS
AND SUSTAINABILITY

Job Title
Signing & Lining Programme 2015/16

Drawing Title
30mph Speed Limit, Shirenewton Road.

Drawn By
GK

Scale
NTS

Checked
MJD

Date
30/10/15

Drawing No.
1679

This drawing is reproduced from the original drawing and is not to be used for any other purpose without the written consent of the County Council. It is the responsibility of the user to ensure that the drawing is used in accordance with the original drawing and is not to be used for any other purpose without the written consent of the County Council.



Rev



monmouthshire
sir fynwy

Future Generations Evaluation (includes Equalities and Sustainability Impact Assessments)

<p>Name of the Officer - Paul Keeble Phone no: 01633 644873 E-mail: paulkeeble@monmouthshire.gov.uk</p>	<p>Please give a brief description of the aims of the proposal: To implement new or amendment of existing traffic orders to improve safety and movement of traffic set out in accordance with the Road Traffic Regulation Act 1984</p>
<p>Name of Service – Traffic & Development</p>	<p>Date Future Generations Evaluation – 07/06/16</p>

NB. Key strategies and documents that may help you identify your contribution to the wellbeing goals and sustainable development principles include: Single Integrated Plan, Continuance Agreement, Improvement Plan, Local Development Plan, People Strategy, Asset Management Plan, Green Infrastructure SPG, Welsh Language Standards, etc



1. Does your proposal deliver any of the well-being goals below? Please explain the impact (positive and negative) you expect, together with suggestions of how to mitigate negative impacts or better contribute to the goal.



Well Being Goal	Does the proposal contribute to this goal? Describe the positive and negative impacts.	What actions have been/will be taken to mitigate any negative impacts or better contribute to positive impacts?
A prosperous Wales	Neutral	

Well Being Goal	Does the proposal contribute to this goal? Describe the positive and negative impacts.	What actions have been/will be taken to mitigate any negative impacts or better contribute to positive impacts?
Efficient use of resources, skilled, educated people, generates wealth, provides jobs		
A resilient Wales Maintain and enhance biodiversity and ecosystems that support resilience and can adapt to change (e.g. climate change)	Neutral	
A healthier Wales People's physical and mental wellbeing is maximized and health impacts are understood	Neutral	
A Wales of cohesive communities Communities are attractive, viable, safe and well connected	Positive	Reduced speeds will improve highway safety and contribute to providing a safer environment for residents/visitors etc.
A globally responsible Wales Taking account of impact on global well-being when considering local social, economic and environmental wellbeing	Neutral	
A Wales of vibrant culture and thriving Welsh language Culture, heritage and Welsh language are promoted and protected. People are encouraged to do sport, art and recreation	Neutral	

Well Being Goal	Does the proposal contribute to this goal? Describe the positive and negative impacts.	What actions have been/will be taken to mitigate any negative impacts or better contribute to positive impacts?
A more equal Wales People can fulfil their potential no matter what their background or circumstances	Neutral	

2. How has your proposal embedded and prioritised the sustainable governance principles in its development?

Sustainable Development Principle	Does your proposal demonstrate you have met this principle? If yes, describe how. If not explain why.	Are there any additional actions to be taken to mitigate any negative impacts or better contribute to positive impacts?
 <p>Long Term</p> <p>Balancing short term need with long term and planning for the future</p>	N/A	
 <p>Collaboration</p> <p>Working together with other partners to deliver objectives</p>	N/A	

Sustainable Development Principle	Does your proposal demonstrate you have met this principle? If yes, describe how. If not explain why.	Are there any additional actions to be taken to mitigate any negative impacts or better contribute to positive impacts?
 <p>Involvement views</p> <p>Involving those with an interest and seeking their views</p>	<p>Full statutory consultation has taken place in accordance with the Road Traffic Regulation Act 1984</p>	
 <p>Prevention</p> <p>Putting resources into preventing problems occurring or getting worse</p>	<p>N/A</p>	

Sustainable Development Principle	Does your proposal demonstrate you have met this principle? If yes, describe how. If not explain why.	Are there any additional actions to be taken to mitigate any negative impacts or better contribute to positive impacts?
 <p data-bbox="237 600 376 632">Integration</p> <p data-bbox="203 659 539 767">Considering impact on all wellbeing goals together and on other bodies</p>	N/A	

3. Are your proposals going to affect any people or groups of people with protected characteristics? Please explain the impact, the evidence you have used and any action you are taking below. For more detailed information on the protected characteristics, the Equality Act 2010 and the Welsh Language Standards that apply to Monmouthshire Council please follow this link: <http://hub/corporatedocs/Equalities/Forms/AllItems.aspx> or contact Alan Burkitt on 01633 644010 or alanburkitt@monmouthshire.gov.uk

Protected Characteristics	Describe any positive impacts your proposal has on the protected characteristic	Describe any negative impacts your proposal has on the protected characteristic	What has been/will be done to mitigate any negative impacts or better contribute to positive impacts?
Age	N/A		
Disability	N/A		

Protected Characteristics	Describe any positive impacts your proposal has on the protected characteristic	Describe any negative impacts your proposal has on the protected characteristic	What has been/will be done to mitigate any negative impacts or better contribute to positive impacts?
Gender reassignment	N/A		
Marriage or civil partnership	N/A		
Pregnancy or maternity	N/A		
Race	N/A		
Religion or Belief	N/A		
Sex	N/A		
Sexual Orientation	N/A		
Welsh Language	N/A		

- 4. Council has agreed the need to consider the impact its decisions has on important responsibilities of Corporate Parenting and safeguarding. Are your proposals going to affect either of these responsibilities?** For more information please see the guidance <http://hub/corporatedocs/Democratic%20Services/Safeguarding%20Guidance.docx> and for more on Monmouthshire's Corporate Parenting Strategy see <http://hub/corporatedocs/SitePages/Corporate%20Parenting%20Strategy.aspx>

	Describe any positive impacts your proposal has on safeguarding and corporate parenting	Describe any negative impacts your proposal has on safeguarding and corporate parenting	What will you do/ have you done to mitigate any negative impacts or better contribute to positive impacts?
Safeguarding	N/A	N/A	
Corporate Parenting	N/A	N/A	

5. What evidence and data has informed the development of your proposal?

Speed and volume traffic surveys have been undertaken to ascertain existing speeds which informed the decision to reduce the current speed limit.

6. SUMMARY: As a result of completing this form, what are the main positive and negative impacts of your proposal, how have they informed/changed the development of the proposal so far and what will you be doing in future?

The proposal to implement a 30mph speed limit will have an overall positive impact in providing a safer environment for all road users. Lower speeds will also contribute to lower CO² emissions.

7. ACTIONS: As a result of completing this form are there any further actions you will be undertaking? Please detail them below, if applicable.

What are you going to do	When are you going to do it?	Who is responsible	Progress
Implement the order	Following publication of a notice of making	Traffic & Development Team	On-going

8. MONITORING: The impacts of this proposal will need to be monitored and reviewed. Please specify the date at which you will evaluate the impact, and where you will report the results of the review.

The impacts of this proposal will be evaluated on:	6-12 months following implementation, speed & volume surveys will be undertaken to ascertain compliance levels.
--	---

9. VERSION CONTROL: The Future Generations Evaluation should be used at the earliest stages of decision making, and then honed and refined throughout the decision making process. It is important to keep a record of this process so that we can demonstrate how we have considered and built in sustainable development wherever possible.

Version No.	Decision making stage	Date considered	Brief description of any amendments made following consideration
			<i>This will demonstrate how we have considered and built in sustainable development throughout the evolution of a proposal.</i>

--	--	--	--